

**Locking sleeves**

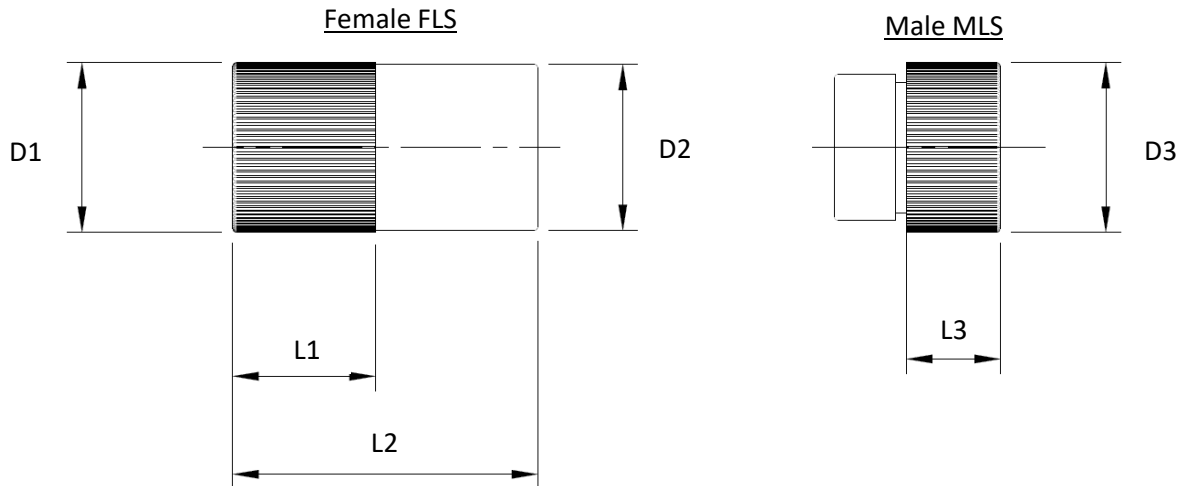

**Locking Sleeve Dimensions**

PN	Reference PN	Application	D1 [mm]	D2 [mm]	D3 [mm]	L1 [mm]	L2 [mm]	L3 [mm]
FLS-A MLS-A	DLSA-F DLSA-M	SC 2-5 MC-SU 9-16 HD 2-4	34	33	34	16	32	23
FLS-B MLS-B	DLSB-F DLSB-M	SC 6-10	40	39	39	16.5	32.5	23
FLS-C MLS-C	DLSC-F DLSC-M	SC 12,16	59	59	59	30	30	19.5
FLS-MC MLS-MC	MCDLS-F MCDLS-M	MC 2-8 METAL SHELL 1500	23	22.5	23	19.3	41.3	12.7
FLS-MCA MLS-MCA		MC 9-16	34	33	34	26.7	52.7	23
FLS-TC MLS-TC		TC	17.3	16.5	16.5	20	36	10
FLS-NA MLS-NA		NANO	17.3	16.5	16.5	20	40.5	15.5
LS2000		METAL SHELL 2000	34	33	NA	16	32	NA
LS2400		METAL SHELL 2400	40	39	NA	16.5	32.5	NA
FLS-A-RM MLS-A-RM	A-FLS-D A-MLS-D	RM size A	17	12.7	17	13.6	45.6	13.5
FLS-G MLS-G	G-FLS-D G-MLS-D	RM size G	28.5	27.5	28.5	22	34.7	11
FLS-K MLS-K	K-FLS-D K-MLS-D	RM size K	36	36	38.1	48	48	17.8
<b>Note:</b> Material: Delrin Black Available Stainless Steel: FLS-A-SS; FLS-MC-SS; MLS-MC-SS; LS2000-SS;								